



10'8" CEILING IN MAIN AREAS  
9'4" CEILING IN BED/GARAGE

# BRUNSWICK II

## Square Footage

Living	2,016
Garage	429
Lanai	224
Entry	57
<b>Total</b>	<b>2,771</b>

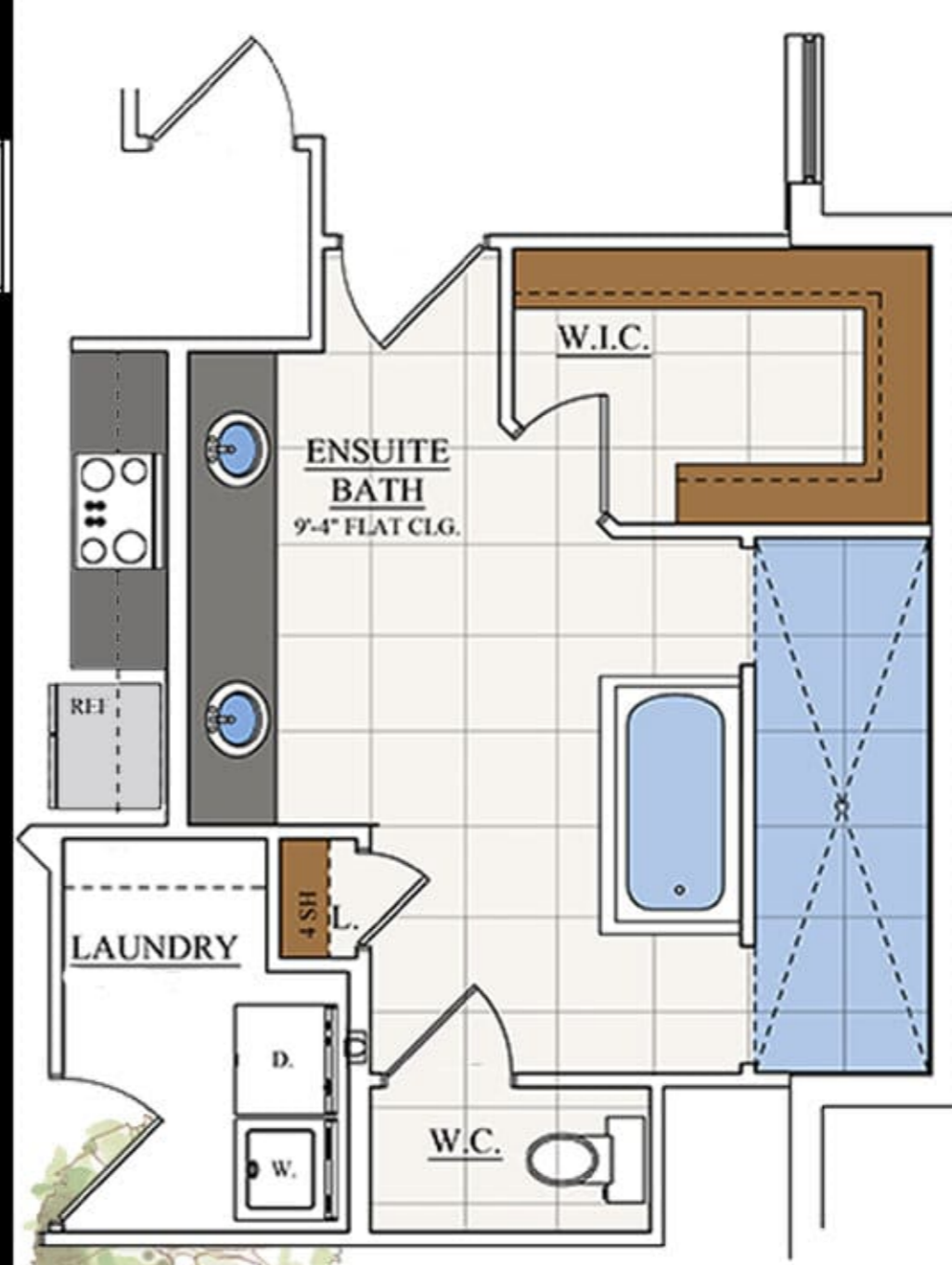

OPTIONAL ENSUITE BATH

© COPYRIGHT 2023  
GROZA BUILDERS, INC

511 SW Port St. Lucie Blvd.  
Port St. Lucie, FL 34953  
LIC# CGC1524734  
772-336-7653  
[www.grozahomes.com](http://www.grozahomes.com)

All dimensions and specifications are approximate and subject to change in the field. Rendering and floor plan are for illustrative purposes only and may not reflect the actual characteristics of the home. Please discuss options with your sales person.

